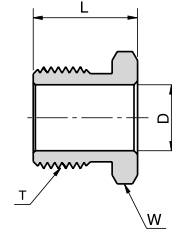
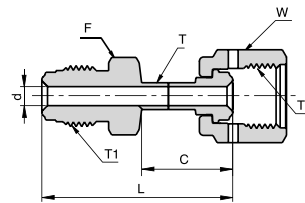

SNM

SHORT MALE NUT

Ordering Information	Face Seal Size	L		D		W	T
	inch	mm	inch	mm	inch	inch	Thread Size
P-SNM 1/4 .54	1/4	13.7	0.54	9.2	0.36	5/8	9/16-18
P-SNM 1/4 .65	1/4	16.5	0.65	9.2	0.36	5/8	9/16-18

UMF

FEMALE TO MALE UNION

Ordering Information	Face Seal Size	L		C		d		F	W	T	T1	T2
	inch	mm	inch	mm	inch	mm	inch	inch	inch	inch	inch	inch
P-UMF-1/4 X 1/4	1/4	45.2	1.78	21.6	0.85	4.6	0.18	5/8	3/4	1/4	9/16 - 18	9/16 - 18
P-UMF-1/2 X 1/2	1/2	49.8	1.96	22.1	0.87	10.2	0.40	15/16	1-1/16	1/2	7/8 - 14	7/8 - 14

MCF

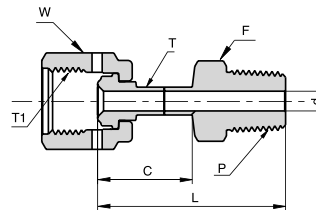
FEMALE TO MALE NPT CONNECTOR

Ordering Information	Face Seal Size	L		C		d		F	W	T	T1	P
	inch	mm	inch	mm	inch	mm	inch	inch	inch	Tube O.D.	Thread Size	NPT-M
P-MCF-1/4 X 1/4	1/4	45.5	1.79	23.4	0.92	4.6	0.18	9/16	3/4	1/4	9/16 - 18	1/4
P-MCF-1/2 X 1/2	1/2	53.1	2.09	25.6	1.01	10.2	0.40	7/8	1 1/16	1/2	7/8 - 14	1/2

Dimensions are for reference only, and are subject to change without notice.
When ordering, be sure to add the Surface-Finish Designator (either H or E) to the Part Number. (See Material Table, page 157).